



Bathline

Newsletter for
Bath Cabinetry
Showrooms

Published by
Woodpro Cabinetry, Inc.
330 Walnut St. Cabool, Missouri
www.woodpro.com

2017 Issue 2



Royale Series Changes, Additions and Reduced Prices

Effective March 27, 2017 for Bedford, Quentin, Revere, Springhill, Tuscany and Ulverston Collections



New! 36" Chest Vanity Model shown in Tuscany Shaker in Maple Painted Taupe. Optional Hardware is shown.

We're excited to announce our revamped Royale Series, which includes Soft Close Drawer Glides and the addition of our popular Chest Vanity models. The Royale collections will have the following changes and additions along with some price reductions:

Royale Changes

- Soft Close full access undermount drawer glides (this replaces the current epoxy coated undermount 3/4 extension drawer glides).
- 5/8" Baltic Birch plywood English Dovetail drawer box with 1/4" Birch plywood drawer bottom (no change to this feature).
- Door panels of 1/4" plywood for door styles of Shaker, Wilton and Old Town.¹
- Door Style of Zenith discontinued for Royale and Classic.¹
- 1/2" Vanity ends changed to full MDF (Medium Density Fiberboard) Core rather than combination veneer and MDF core.¹
- Quentin RTF white vanity ends will have white vinyl face and back with MDF core.

¹ Classic Series collections of Coventry and Jasper will change to this feature at the same time as Royale.

What's Inside:

- Premier to Royale Comparison 2-3
- Fairfax Door Changed 3
- 42" Chest Vanity Limitation 3
- New Chest Vanity Prices 4-5
- Updated Royale Vanity Prices 6-11
- Updated Royale Linen Prices 12-13
- New Granite 3/4" Thick Tops 14

Royale Additions

- Our popular new Chest Vanity models added to Royale. Details and prices for these are on pages 4-5 and will be in our online catalog. These are available in all Royale Collections except Quentin.
- Soft Close Door Option (\$7 add-on list price per door).
- Pullout Tray Option (\$165 add-on list price per tray).
- Veneer Core Plywood End Option (\$35 add-on list price for vanity, and \$75 add-on list price for linen cabinet).

Royale Price Reduction

Due to the change in features, all Royale vanity, linen cabinet and toilet topper prices (except for Quentin and Oak Wood) are reduced by 5%. See the attached Royale price pages and the online catalog at www.woodpro.com for the new prices.

Natural Granite Tops 3/4" Thick Added to Compliment Royale Vanities

These value priced tops are available in 5 sizes (2522, 3122, 3722, 4322 and 4922). They are available in Wheat and Meteorite colors with 8" faucet drilling and a White oval undermount bowl. See page 14 for color samples, prices and additional details.

Royale Collections have Premier Equivalents



- Bedford (B) corresponds to Ashford (A) in Premier.
- Revere (R) corresponds to Lambiere (L) in Premier.
- Springhill (S) corresponds to Gentry (G) in Premier.
- Tuscany (T) corresponds to Heirloom (H) in Premier.
- Ulverston (U) corresponds to Estate (E) in Premier.
- Quentin (Q) does not have a corresponding collection in Premier. It is white with Rigid Thermal Foil (RTF) door and drawer fronts.



(At left) Royale Series Revere Ensemble with 30" 2-Door and 1-Drawer Vanity, Wheat Granite Top, and Framed Mirror shown in Maple wood with Sable.

(At right) Royale Series Revere Ensemble with 30" 2-Door and 1-Drawer Vanity, Meteorite Granite Top, and Framed Mirror shown in Maple wood in Painted White.

Premier to Royale Feature Comparison

Premier

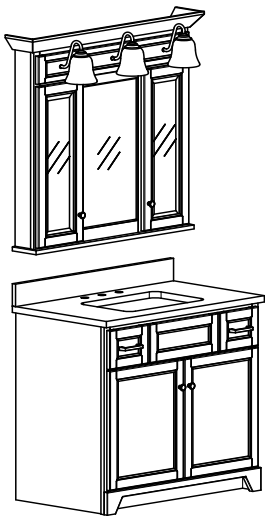

Royale

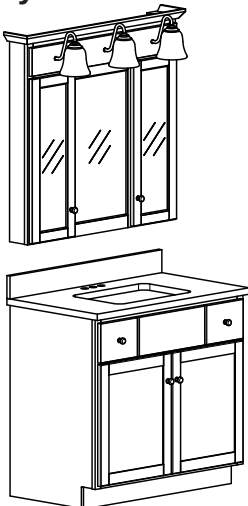

Feature	Premier	Royale
Collection Equivalents	Ashford (A) Gentry (G) Lambiere (L) Heirloom (H) Estate (E)	Bedford (B) Springhill (S) Revere (R) Tuscany (T) Ulverston (U)
Vanity Height	33 1/2"	33 1/2"
Drawers	English Dovetail 5/8" Solid Wood	English Dovetail 5/8" Baltic Birch Plywood
Drawer Glides	Premium Soft Close Full Extension Undermount	Soft Close Full Access Undermount
Door Hinges	Concealed Soft Close	Concealed
Door Panels for Shaker, Wilton, & Old Town Styles	Solid Wood	1/4" Plywood
Door Style Choices	All	All except: Edgewood Fairfax Ridgefield Villa Zenith
Wood Choices	Cherry Cherry Rustic Maple Oak	Cherry Cherry Rustic Maple Oak
Finish Choices	All	All
Drawer below sink door: Vanities	Yes	Yes
Dresser Vanities	Yes	No
Chest Vanities	Yes	Yes
Breakfront Vanities	Yes	Yes
Wall-Mount Vanities	Yes	No
Design Pieces	All	Basic bases & desk drawers
3-Piece Models	66"-96"	66"-72"
Toe Kick	Captured or with Skirt	Notched



Updated Fairfax door
Maple White painted
with Pewter Glaze

Royale Series

36" Ensemble shown in Springhill Shaker
in Cherry Wood with Medium and Black
Glaze. Item #BD3621RSECMB.



Fairfax Door Style Changed

Effective March 27th, the Bead Edge Fairfax door raised panel is changed to our typical raised panel shape, like Prestige. This change is due to the difficulty we have during our finish process with the current shape. This new raised panel is the typical industry standard for Bead Edge raised panel door style.

42" Chest Vanity Limitation

Effective immediately, our 42" Chest Vanity Models will continue to be available in Premier Collections of Estate, Fireside, Heirloom, Monterey, Nottingham, Ovation and Parkway. Due to production challenges, 42" Chest Models will no longer be available in Ashford, Gentry, Lambiere, and Valencia.

Premier Series Advantages over Royale Series

- Solid Maple Wood English Dovetail Drawer Box.
- Premium Soft Close Full Extension Undermount drawer glides.
- Soft Close doors
- Skirt or captured Toe Board
- Base divider between sink and drawers
- Larger Crown Molding
- Beveled Mirrors in mirrored cabinets and framed mirrors
- More collection, door style and model choices.



Woodpro Cabinetry, Inc.
Bathline Editor: Tammy Johnson
Phone
1.888.2Woodpro
(1.888.296.6377)
Fax
1.888.962.5332
Web
www.woodpro.com

Sales Management: Glen Walls and Eddy Noll
Sales Agencies: All-Pro Marketing, C & C Marketing, Dolphin Marketing Group, DTP & Associates, Highline Sales, Holliday Sales, Inc., JAS Inc., Northeast Sales Group, PD Sales, Pesiri Sales, Robert Ellsworth Assoc., Target Sales & Marketing, Thomas Weir & Assoc., Triangle Sales, and Winger Sales.

Customer Service: Glendela Smith, Melissa Elliott, Bridget Bergfels, and Lisa Windsor



Chest Drawer Vanities 24" - 48" Wide

Example Item Number	Depth	1 Model Number	2 Collection Code (B, R, S)	3 Door Style Code (O, P, S, W)	4 Wood and Color Code	List
PD2421- B P C M-	21 3/4"	PD2421-	B	P	C M-	\$1,311
PD2418- B P C M-	18 3/4"	PD2418-	B	P	C M-	\$1,311

2 Collection Code:	Bedford (B) or Revere (R)	Springhill (S)
3 Door Style Code:	P S W Prestige Shaker Wilton	O P S W Old Town Prestige Shaker Wilton
See page 1.5 for Best Seller and Recommended Door Style Choices.		

4 Wood & Color:	STAIN	STAIN	STAIN	STAIN	STAIN	STAIN
See Wood-color pages 7.1-7.2 Cherry Rustic listed as C Rustic	Oak	Cherry C Rustic Maple	—	Oak	Cherry C Rustic Maple	—
	GLAZE or PAINT Oak	GLAZE or PAINT Cherry C Rustic Maple		GLAZE or PAINT Oak	GLAZE or PAINT Cherry C Rustic Maple	

Ref	Notes	1 Model Number						
24" Chest Drawer Vanities			21 3/4" (or 18 3/4" or 24 3/4")D x 33 1/2"H					
A	1,2,3	PD2421-	1192	1311	1422	1273	1400	1540
D	1,2,3	PE2421-	1280	1408	1549	1400	1540	1694
27" Chest Drawer Vanities			21 3/4" (or 18 3/4" or 24 3/4")D x 33 1/2"H					
A	1,2,3	PD2721-	1314	1445	1590	1396	1536	1689
D	1,2,3	PE2721-	1402	1542	1696	1523	1675	1843
30" Chest Drawer Vanities			21 3/4" (or 18 3/4" or 24 3/4")D x 33 1/2"H					
A	1,2,3	PD3021-	1438	1582	1740	1519	1671	1838
D	1,2,3	PE3021-	1525	1678	1845	1646	1811	1992
33" Chest Drawer Vanities			21 3/4" (or 18 3/4" or 24 3/4")D x 33 1/2"H					
A	1,2,3	PD3321-	1561	1717	1889	1641	1805	1986
D	1,2,3	PE3321-	1648	1813	1994	1769	1546	2140
36" Chest Drawer Vanities			21 3/4" (or 18 3/4" or 24 3/4")D x 33 1/2"H					
B	1,2	PD3621-	1683	1851	2036	1764	1940	2134
E	1,2	PE3621-	1771	1948	2143	1891	2080	2288
48" Chest Drawer Vanities			21 3/4" (or 18 3/4" or 24 3/4")D x 33 1/2"H					
C	1,2	PD4821E	2492	2741	3015	2734	3007	3308
F	1,2	PE4821E	2667	2934	3227	3030	3333	3666

Notes & Exceptions

- 21 3/4" deep models are listed. For 18 3/4" deep models at the same price, place the "18" in position 5-6 of the Model Number.
- 1 Wilton door style is not available in Cherry Rustic.
- 2 Cherry Rustic wood is not available in Revere.
- 3 For optional decorative hardware on the top false drawer, state option and add \$55 to list price.

Cabinet graphics are shown below with nonspecific hardware, and Zenith (Z) door style. See pages 1.6-1.16 for specific Collection and Door style information.

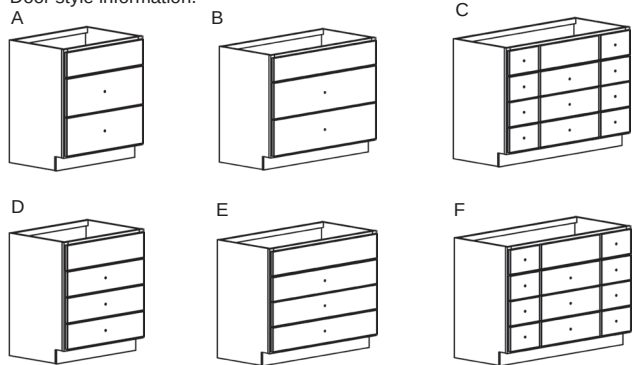

- New Chest Vanities with "Pipe Chase Drawers" have the look of a 3-drawer chest of drawers. Pipe Chase drawers are constructed to give as much drawer space as possible while clearing the sink bowl and plumbing pipes. Configurations vary by vanity Width and Construction Type (Overlay or Molding Overlay).
- Overlay (O) Collections are: Bedford, Revere and Springhill. Molding Overlay (MO) Collections are: Tuscany and Ulverston.
- For 24" – 36" one drawer stack models, the middle Pipe Chase Drawer (see photo, page 1.53) only has to clear the plumbing pipes. The width allowed in the center back of this middle drawer is 7" and the depth, from the back of the cabinet is 14". The top drawer is a false drawer front.
- For the 48" three drawer stack models, all drawers will be functioning drawers except below the sinkwell. The drawers below the sink will have 7" clearance between the drawers for the drain pipes. See www.woodpro.com for additional specifications.

Chest Drawer Vanities 24" - 48" Wide

Example Item Number	Depth	1	Model Number	2	Collection Code (T,U)	3	Door Style Code (O, P, S, W)	4	Wood and Color Code	List
PD2421- T P C M-	21 3/4"		PD2421-		T		P		C M-	\$1,489
PD2418- T P C M-	18 3/4"		PD2418-		T		P		C M-	\$1,489

		2 Collection Code:				Tuscany (T)			Ulverston (U)			
		3 Door Style Code: See page 1.5 for Best Seller and Recommended Door Style Choices.				O Old Town	P Prestige	S Shaker	W Wilton	P Prestige	S Shaker	W Wilton
		4 Wood & Color: See Wood-color pages 7.1-7.2 Cherry Rustic listed as C Rustic				STAIN Oak	STAIN Cherry Maple	STAIN —	STAIN Oak	STAIN Cherry Maple	STAIN —	
Ref	Notes	1 Model Number				GLAZE or PAINT Oak	GLAZE or PAINT Cherry Maple	GLAZE or PAINT Cherry Maple	GLAZE or PAINT Oak	GLAZE or PAINT Cherry Maple	GLAZE or PAINT Cherry Maple	
24" Chest Drawer Vanities						21 3/4" (or 18 3/4" or 24 3/4")D x 33 1/2"H						
A	1	PD2421-	1354	1489	1638	1354	1489	1638				
D	1	PE2421-	1521	1673	1840	1521	1673	1840				
27" Chest Drawer Vanities						21 3/4" (or 18 3/4" or 24 3/4")D x 33 1/2"H						
A	1	PD2721-	1477	1625	1787	1477	1625	1787				
D	1	PE2721-	1644	1808	1989	1644	1808	1989				
30" Chest Drawer Vanities						21 3/4" (or 18 3/4" or 24 3/4")D x 33 1/2"H						
A	1	PD3021-	1600	1760	1936	1600	1760	1936				
D	1	PE3021-	1767	1944	2138	1767	1944	2138				
33" Chest Drawer Vanities						21 3/4" (or 18 3/4" or 24 3/4")D x 33 1/2"H						
A	1	PD3321-	1722	1894	2084	1722	1894	2084				
D	1	PE3321-	1890	2079	2287	1890	2079	2287				
36" Chest Drawer Vanities						21 3/4" (or 18 3/4" or 24 3/4")D x 33 1/2"H						
B	1	PD3621-	1845	2030	2232	1845	2030	2232				
E	1	PE3621-	2012	2213	2435	2012	2213	2435				
48" Chest Drawer Vanities						21 3/4" (or 18 3/4" or 24 3/4")D x 33 1/2"H						
C		PD4821E	2976	3274	3601	2976	3274	3601				
F		PE4821E	3393	3732	4106	3393	3732	4106				

Notes & Exceptions
 • 21 3/4" deep models are listed. For 18 3/4" deep models at the same price, place the "18" in position 5-6 of the Model Number.
 1 For optional decorative hardware on the top false drawer, state option and add \$55 to list price.

ROYALE VANITIES

Cabinet graphics are shown below with nonspecific hardware, and Zenith (Z) door style. See pages 1.6-1.16 for specific Collection and Door Style information.

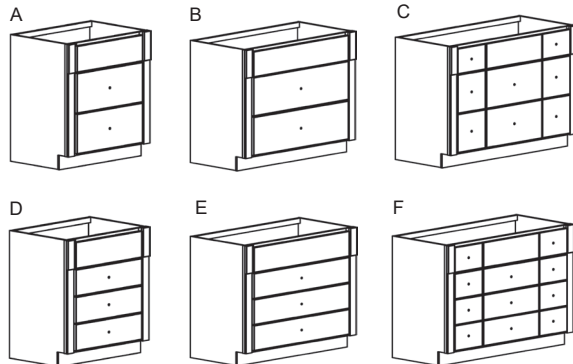

Pipe Chase Drawer. **NEW!**

3 Vanities 18" – 42" Wide & Breakfront Bowl Left Right 36", 39" and 45"

Example Item Number	Depth	1 Model Number	2 Collection Code (B,Q,R,S)	3 Door Style Code (O,P,S,W)	4 Wood and Color Code	List
BV2421- B P C M-	21 3/4"	BV2421-	B	P	C M-	\$735
BV2418- B P C M-	18 3/4"	BV2418-	B	P	C M-	\$735

2 Collection Code:	Bedford (B) or Revere (R)	Quentin (Q)	Springhill (S)
3 Door Style Code:	P Prestige	S Shaker	W Wilton
See page 3.2 for Best Seller and Recommended Door Style Choices.			
4 Wood & Color:	STAIN Oak	STAIN Cherry C Rustic Maple	STAIN —
See Wood-Color Brochure pages 7.1-7.2	GLAZE or PAINT Oak	GLAZE or PAINT Cherry C Rustic Maple	RTF Maple-White
Ref	Notes	Model Number	

Cabinet graphics are shown below with nonspecific hardware, and Zenith (Z) door style. See pages 3.4-3.9 for specific Collection and Door Style information.

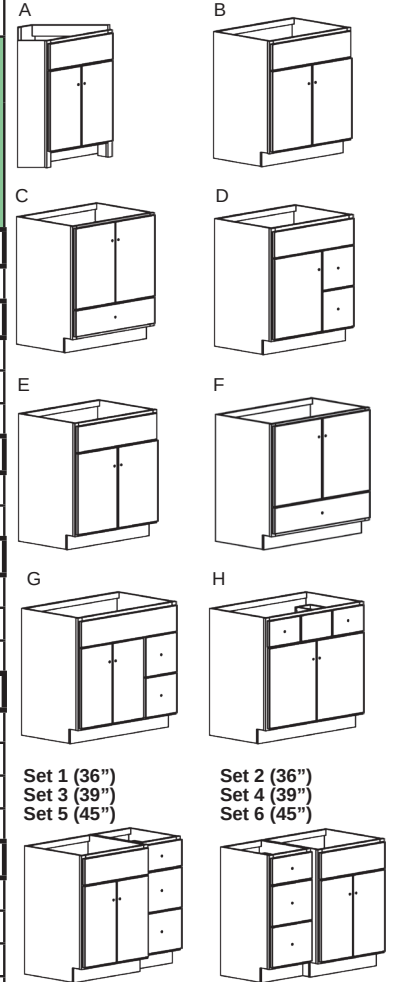

Corner Vanity		24 1/2"W x 23 1/2"D x 33 1/2"H							
A	1	BVCV2D-	819	860	950	NA	819	860	950

24" Vanities		24"W x 21 3/4" (or 18 3/4")D x 33 1/2"H							
B	1	BV2421-	700	735	812	634	700	735	812
C	1,4	BV2421Q	893	938	1036	NA	893	938	1036
D	1,2	BD2421R	798	838	926	736	881	925	1022

27" Vanities		27"W x 21 3/4" (or 18 3/4")D x 33 1/2"H							
B	1	BV2721-	772	811	896	NA	772	811	896
C	1,4	BV2721Q	966	1014	1121	NA	966	1014	1121

30" Vanities		30"W x 21 3/4" (or 18 3/4")D x 33 1/2"H							
B	1	BV3021-	845	887	980	NA	845	887	980
C	1,4	BV3021Q	1038	1090	1204	NA	1038	1090	1204
D	1,2	BD3021R	973	1022	1129	910	1055	1108	1224

36" Vanities		36"W x 21 3/4" (or 18 3/4")D x 33 1/2"H							
E	1	BV3621-	990	1040	1148	923	990	1040	1148
F	1,4	BV3621Q	1218	1279	1413	NA	1218	1279	1413
G	1,2	BD3621R	1141	1198	1324	1054	1222	1283	1418
H	1	BV3621E	1141	1198	1324	NA	1141	1198	1324

42" Vanities		42"W x 21 3/4" (or 18 3/4")D x 33 1/2"H							
E	1	BV4221-	1134	1191	1315	NA	1134	1191	1315
F	1,4	BV4221Q	1363	1431	1581	NA	1363	1431	1581
G	1,2	BD4221R	1285	1349	1491	NA	1368	1436	1587
H	1,5	BV4221E	1285	1349	1491	NA	1285	1349	1491

2-Piece Breakfront Left/Right Vanity Sets 36", 39" and 45" Widths		21 3/4" D x 33 1/2"H							
1	1,3	1B36211	1586	1665	1840	NA	1670	1754	1937
2	1,3	1B36212	1586	1665	1840	NA	1670	1754	1937
3	1,3	1B39211	1713	1799	1987	NA	1796	1886	2083
4	1,3	1B39212	1713	1799	1987	NA	1796	1886	2083
5	1,3	1B45211	1858	1951	2155	NA	1941	2038	2251
6	1,3	1B45212	1858	1951	2155	NA	1941	2038	2251

Vanity Fillers		3" or 6" W x 3/4"D							
I	1,5,6	BSFBV3-	69	69	69	69	69	69	69
I	1,5,6	BSFBV6-	88	88	88	88	88	88	88

Notes & Exceptions

- 21 3/4" deep models are listed. For 18 3/4" deep models at the same price, place "18" in position 5-6 of the Model Number.
- For Breakfront Left/ Right vanities, the sink bowl cabinet is 21 3/4" deep and the drawered cabinet is 18 3/4" deep.

1 Cherry Rustic wood is not available in Revere Collection. Wilton door style is not available in Cherry Rustic.
 2 For drawers on left, place an "L" in position 7 of Model Number.
 3 For the 36" or 39" sets model, the bowl center is 12" from the end and for the 45" model the bowl center is 15" from the end.
 4 This model has room in the drawer to store rolls of toilet tissue.
 5 A filler is not counted as a piece for quantity discounts.
 6 For this model use a "-" for the door style code.

• Component information for Breakfront Sets are found on page 3.26.



ROYALE VANITIES

Vanities 18" – 42" Wide & Breakfront Bowl Left Right 36", 39" and 45" 3

Example Item Number	Depth	1	Model Number	2	Collection Code (T,U)	3	Door Style Code (O, P, S, W)	4	Wood and Color Code	List
BV2421- T S C M-	21 3/4"		BV2421-		T		S		C M-	\$798
BV2418- T S C M-	18 3/4"		BV2418-		T		S		C M-	\$798

Cabinet graphics are shown below with nonspecific hardware, and Zenith (Z) door style. See pages 3.4-3.9 for specific Collection and Door Style information.

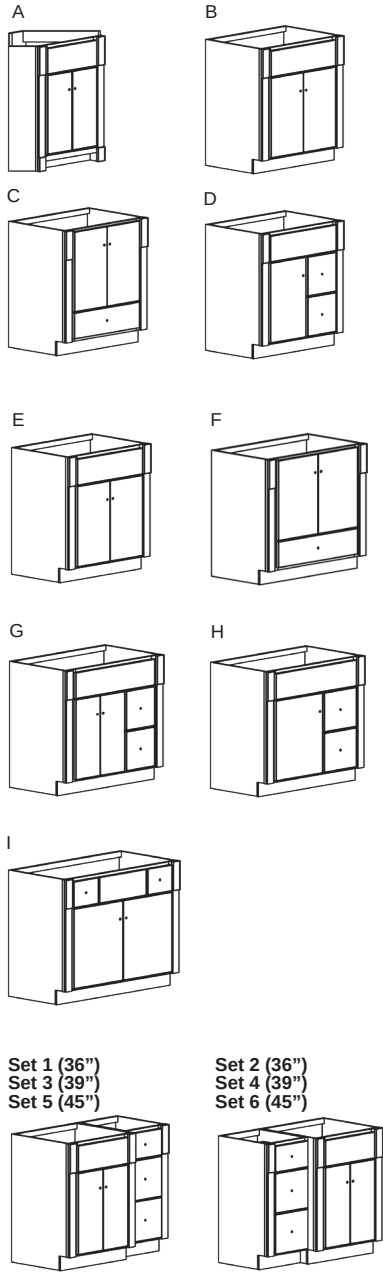

Component information for Breakfront Sets are found on page 3.27.

2		Tuscany (T)				Ulverston (U)		
3		O	P	S	W	P	S	W
4		STAIN		STAIN		STAIN		STAIN
1		OAK		CHERRY MAPLE		CHERRY MAPLE		OAK
Ref		Notes		Model Number		GLAZE or PAINT		GLAZE or PAINT
		OAK		CHERRY MAPLE		OAK		CHERRY MAPLE
Corner Vanity 24 1/2"W x 23 1/2"D x 33 1/2"H								
A		BVCV2D-	879	923	1020	879	923	1020
24" Vanities 24"W x 21 3/4" (or 18 3/4")D x 33 1/2"H								
B		BV2421-	760	798	882	760	798	882
C	4	BV2421Q	953	1001	1105	953	1001	1105
27" Vanities 27"W x 21 3/4" (or 18 3/4")D x 33 1/2"H								
B		BV2721-	832	874	965	832	874	965
C	4	BV2721Q	1026	1077	1190	1026	1077	1190
30" Vanities 30"W x 21 3/4" (or 18 3/4")D x 33 1/2"H								
B		BV3021-	905	950	1050	905	950	1050
C	4	BV3021Q	1098	1153	1274	1098	1153	1274
D	1	BD3021R	1115	1171	1293	1115	1171	1293
36" Vanities 36"W x 21 3/4" (or 18 3/4")D x 33 1/2"H								
E		BV3621-	1050	1103	1218	1050	1103	1218
F	4	BV3621Q	1278	1342	1482	1278	1342	1482
G	1	BD3621R	1282	1346	1487	1282	1346	1487
H	3	BD3621M	1247	1309	1447	1247	1309	1447
42" Vanities 42"W x 21 3/4" (or 18 3/4")D x 33 1/2"H								
E		BV4221-	1194	1254	1385	1194	1254	1385
F	4	BV4221Q	1423	1494	1651	1423	1494	1651
G	1	BD4221R	1427	1498	1655	1427	1498	1655
I		BV4221E	1345	1412	1560	1345	1412	1560
2-Piece Breakfront Left/Right Vanity Sets 36", 39" and 45" Widths 21 3/4" D x 33 1/2"H								
1	2	1B36211	1769	1857	2052	1769	1857	2052
2	2	1B36212	1769	1857	2052	1769	1857	2052
3	2	1B39211	1896	1991	2200	1896	1991	2200
4	2	1B39212	1896	1991	2200	1896	1991	2200
5	2	1B45211	2041	2143	2368	2041	2143	2368
6	2	1B45212	2041	2143	2368	2041	2143	2368
Vanity Fillers 3" or 6" W x 3/4"D								
J	5,6	BSFBV3-	69	69	69	69	69	69
J	5,6	BSFBV6-	88	88	88	88	88	88

Notes & Exceptions

- 21 3/4" deep models are listed. For 18 3/4" deep models at the same price, place the "18" in position 5-6 of the Model No.
- For Breakfront Left/ Right vanities, the sink bowl cabinet is 21 3/4" deep and the drawered cabinet is 18 3/4" deep.

1 For drawers on left, place an "L" in position 7 of model number.
 2 For the 36" or 39" sets model, the bowl center is 12" from the end and for the 45" model the bowl center is 15" from the end.
 3 For drawers on left, place a "K" in position 7 of the model number.
 4 This model has room in the drawer to store rolls of toilet tissue.
 5 For this model use a "-" for the door style code.
 6 A filler is not counted as a piece for quantity discounts.

ROYALE VANITIES

3 Vanities 48", 54" and 60" Wide

Example Item Number	Depth	1	Model Number	2	Collection Code (B,Q,R,S)	3	Door Style Code (O,P,S,W)	4	Wood and Color Code	List
BD4821N B P C M-	21 3/4"		BD4821N		B		P		C M-	\$1,578
BD4818N B P C M-	18 3/4"		BD4818N		B		P		C M-	\$1,578

2	Collection Code:	Bedford (B) or Revere (R)	Quentin (Q)	Springhill (S)																								
3	Door Style Code:	<table border="1"> <tr> <th>P</th> <th>S</th> <th>W</th> <th>N</th> <th>O</th> <th>P</th> <th>S</th> <th>W</th> </tr> <tr> <td>Prestige</td> <td>Shaker</td> <td>Wilton</td> <td>Newport</td> <td>Old Town</td> <td>Prestige</td> <td>Shaker</td> <td>Wilton</td> </tr> <tr> <td></td> <td></td> <td></td> <td></td> <td></td> <td></td> <td></td> <td></td> </tr> </table>			P	S	W	N	O	P	S	W	Prestige	Shaker	Wilton	Newport	Old Town	Prestige	Shaker	Wilton								
P	S	W	N	O	P	S	W																					
Prestige	Shaker	Wilton	Newport	Old Town	Prestige	Shaker	Wilton																					
4	Wood & Color:	STAIN Oak GLAZE or PAINT Oak	STAIN Cherry C Rustic Maple GLAZE or PAINT Cherry C Rustic Maple	STAIN — GLAZE or PAINT Cherry C Rustic Maple RTF Maple-White	STAIN Oak GLAZE or PAINT Oak	STAIN Cherry C Rustic Maple GLAZE or PAINT Oak	STAIN — GLAZE or PAINT Cherry C Rustic Maple																					
Ref	Notes	1		Model Number																								

48" Vanities 48"W x 21 3/4" (or 18 3/4")D x 33 1/2"H

A	1	BD4821N	1503	1578	1743	1396	1668	1751	1935
B	1	BD4821E	1577	1656	1829	NA	1740	1827	2018
C	1,5	BD4821Q	1769	1857	2052	NA	1934	2031	2243
D	1,2	BD4821R	1478	1552	1714	NA	1559	1637	1808
E	1	BV4821-	1430	1502	1659	NA	1430	1502	1659
F	1,4	BD48BFE	1976	2075	2292	NA	2142	2249	2485

54" Vanities 54"W x 21 3/4" (or 18 3/4")D x 33 1/2"H

B	1	BD5421E	1826	1917	2118	NA	1989	2088	2307
C	1,5	BD5421Q	2019	2120	2342	NA	2183	2292	2532
D	1,2	BD5421R	1728	1814	2004	NA	1810	1901	2100
E	1	BV5421-	1576	1655	1828	NA	1576	1655	1828
F	1,4	BD54BFE	2229	2340	2586	NA	2396	2516	2779

60" Vanities 60"W x 21 3/4" (or 18 3/4")D x 33 1/2"H

B	1	BD6021E	2076	2180	2408	NA	2240	2352	2598
C	1,5	BD6021Q	2269	2382	2632	NA	2433	2555	2822
D	1,2	BD6021R	1977	2076	2293	NA	2059	2162	2388
E	1	BV6021-	1721	1807	1996	NA	1721	1807	1996
F	1,4	BD60BFE	2484	2608	2881	NA	2650	2783	3074
G	1,3	BD6021O	2020	2121	2343	1849	2102	2207	2438

Notes & Exceptions

- 21 3/4" deep models are listed. For 18 3/4" deep models at the same price, place the "18" in position 5-6 of the Model No.
- 1 Cherry Rustic wood is not available in Revere Collection. Wilton door style is not available in Cherry Rustic.
- 2 For drawers on left, place an "L" in position 7 of Model Number.
- 3 Two bowl 60" vanity bowl centers are 12" from each end.
- 4 Center bowl area is 21 3/4" deep and sides are 18 3/4" deep.
- 5 This model has room in the drawer at the bottom to store rolls of toilet paper.

Cabinet graphics are shown below with nonspecific hardware, and Zenith (Z) door style. See pages 3.4-3.9 for specific Collection and Door Style information.

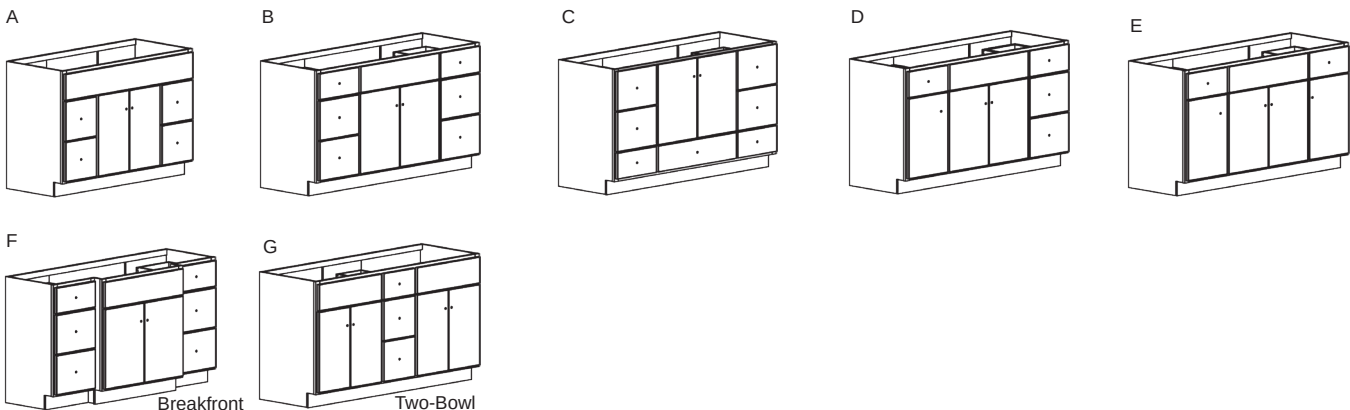

Vanities 48", 54" and 60" Wide

3

Example Item Number	Depth	1	Model Number	2	Collection Code (T,U)	3	Door Style Code (O, P, S, W)	4	Wood and Color Code	List
BD4821N T S C M-	21 3/4"		BD4821N		T		S		C M-	\$1,803
BD4818N T S C M-	18 3/4"		BD4818N		T		S		C M-	\$1,803

2 Collection Code:		Tuscany (T)				Ulverston (U)		
3 Door Style Code: See page 3.2 for Best Seller and Recommended Door Style Choices.		O Old Town	P Prestige	S Shaker	W Wilton	P Prestige	S Shaker	W Wilton
4 Wood & Color: See Wood-Color Brochure pages 7.1-7.2		STAIN Oak	STAIN Cherry Maple	STAIN —	STAIN —	STAIN Oak	STAIN Cherry Maple	STAIN —
Ref	Notes	1 Model Number		GLAZE or PAINT Oak	GLAZE or PAINT Cherry Maple	GLAZE or PAINT Oak	GLAZE or PAINT Cherry Maple	GLAZE or PAINT Cherry Maple

48" Vanities 48"W x 21 3/4" (or 18 3/4")D x 33 1/2"H

A		BD4821N	1717	1803	1992	1717	1803	1992
B		BD4821E	1790	1880	2076	1790	1880	2076
C	4	BD4821Q	1982	2081	2299	1982	2081	2299
D	1	BD4821R	1609	1689	1866	1609	1689	1866
E		BV4821-	1480	1554	1717	1480	1554	1717
F	3	BD48BFE	2252	2365	2612	2252	2365	2612

54" Vanities 54"W x 21 3/4" (or 18 3/4")D x 33 1/2"H

B		BD5421E	2039	2141	2365	2039	2141	2365
C	4	BD5421Q	2232	2344	2589	2232	2344	2589
D	1	BD5421R	1859	1952	2156	1859	1952	2156
E		BV5421-	1624	1705	1884	1624	1705	1884
F	3	BD54BFE	2506	2631	2907	2506	2631	2907

60" Vanities 60"W x 21 3/4" (or 18 3/4")D x 33 1/2"H

B		BD6021E	2289	2403	2655	2289	2403	2655
C	4	BD6021Q	2482	2606	2879	2482	2606	2879
D	1	BD6021R	2108	2213	2445	2108	2213	2445
E		BV6021-	1769	1857	2052	1769	1857	2052
F	3	BD60BFE	2760	2898	3202	2760	2898	3202
G	2	BD6021M	2152	2260	2496	2152	2260	2496

Notes & Exceptions
 • 21 3/4" deep models are listed. For 18 3/4" deep models at the same price, place the "18" in position 5-6 of the Model No.
1 For drawers on left, place an "L" in position 7 of Model Number.
2 Two bowl 60" vanity bowl centers are 13 1/2" from each end.
3 Center bowl area is 21 3/4" deep and sides are 18 3/4" deep.
4 This model has room in the drawer at the bottom to store rolls of toilet paper.

Cabinet graphics are shown below with nonspecific hardware, and Zenith (Z) door style. See pages 3.4-3.9 for specific Collection and Door Style information.

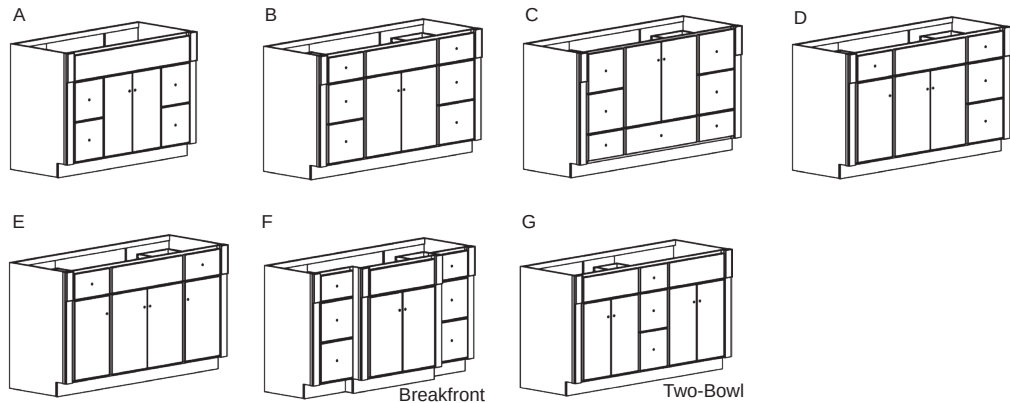

ROYALE VANITIES

3 Vanity Sets 66" and 72" Wide and Set Component Models

Example Item Number	Depth	1	Model Number	2	Collection Code (B,R,S)	3	Door Style Code (O,P,S,W)	4	Wood and Color Code	List
1A66211 B P C M-	21 3/4"		1A66211		B		P		C M-	\$2,990
1A66181 B P C M-	18 3/4"		1A66181		B		P		C M-	\$2,990

2 Collection Code:		Bedford (B) or Revere (R)			Springhill (S)			
3 Door Style Code: See page 3.2 for Best Seller and Recommended Door Style Choices.		P Prestige	S Shaker	W Wilton	O Old Town	P Prestige	S Shaker	W Wilton
4 Wood & Color: See Wood-Color Brochure pages 7.1-7.2		STAIN Oak	STAIN Cherry C Rustic Maple	STAIN —	STAIN Oak	STAIN Cherry C Rustic Maple	STAIN —	STAIN —
Ref	Notes	1 Model Number						

66" Vanity Sets 66"W x 21 3/4" (or 18 3/4")D x 33 1/2"H

1	1	1A66211	2847	2990	3302	3013	3164	3494
3	1,5	1B66211	3101	3256	3596	3267	3430	3790
5	1,4	2A66211	2340	2457	2714	2422	2543	2810

72" Vanity Sets 72"W x 21 3/4" (or 18 3/4")D x 33 1/2"H

2	1	1A72211	2944	3144	3473	3160	3318	3665
4	1,5	1B72211	3248	3410	3767	3436	3608	3986
6	1,4	2A72211	2846	2611	2884	2568	2697	2980

Vanity Base Models for Left/Right End 18"W x 21 3/4" (or 18 3/4")D x 33 1/2"H

A	1,2	AD1821L	1013	1064	1175	1096	1151	1271
B	1,2	AV1821L	786	825	912	786	825	912

Vanity Base Models for Center 18"W x 21 3/4" (or 18 3/4")D x 33 1/2"H

A	1,3	AD1821N	978	1027	1134	1060	1113	1230
---	-----	---------	-----	------	------	------	------	------

Vanity Sink Models for Left/Right End 24", 27" or 30"W x 21 3/4" (or 18 3/4")D x 33 1/2"H

C	1,2,7	BV2421L	681	715	790	681	715	790
C	1,2,7	BV2721L	754	792	875	754	792	875
C	1,2,7	BV3021L	826	867	958	826	867	958

Vanity Sink Models for Breakfront Left/Right End 12", 15" or 18"W x 18 3/4"D x 33 1/2"H

A	1,6	BD12BL-	886	930	1028	970	1019	1125
A	1,6	BD15BL-	1013	1064	1175	1096	1151	1271
A	1,6	BD18BL-	1140	1197	1322	1223	1284	1419

Vanity Sink Models for Center 30" or 36"W x 21 3/4" (or 18 3/4")D x 33 1/2"H

C	1,3	BV3021N	821	862	952	821	862	952
C	1,3	BV3621N	968	1016	1123	968	1016	1123

- Notes & Exceptions
- 21 3/4" deep models are listed. For 18 3/4" deep models at the same price, place the "18" in position 5-6 of the Model No.
 - 1 Cherry Rustic wood is not available in Revere Collection. Wilton door style is not available in Cherry Rustic.
 - 2 The "L" in position 7 of the model number denotes Left End Finished, where the Right end will have a clear-coat finish but will not be stained, painted or glazed. To denote Right End Finished, place an "R" in position 7 of the model number, and the left end will have a clear-coat finish but will not be stained, painted or glazed.
 - 3 The "N" in position 7 of the model number denotes Neither End Finished, where both ends will have a clear-coat finish, but will not be stained, painted or glazed.
 - 4 Two bowl 66" vanity bowl centers are 12" from each end. Two bowl 72" vanity bowl centers are 13 1/2" from each end.
 - 5 For this Breakfront Vanity Set, the Center bowl area is 21 3/4" deep and the sides are 18 3/4" deep.
 - 6 The "L" in position 6 of the model number denotes Left End Finished, where the Right end will have a clear-coat finish but will not be stained, painted or glazed. To denote Right End Finished, place an "R" in position 7 of the model number, and the left end will have a clear-coat finish but will not be stained, painted or glazed.
 - 7 For this model with both ends finished, replace the "L" in position 7 with a "-" dash.

Cabinet graphics are shown below with nonspecific hardware, and Zenith (Z) door style. See pages 3.4-3.9 for specific Collection and Door Style information.

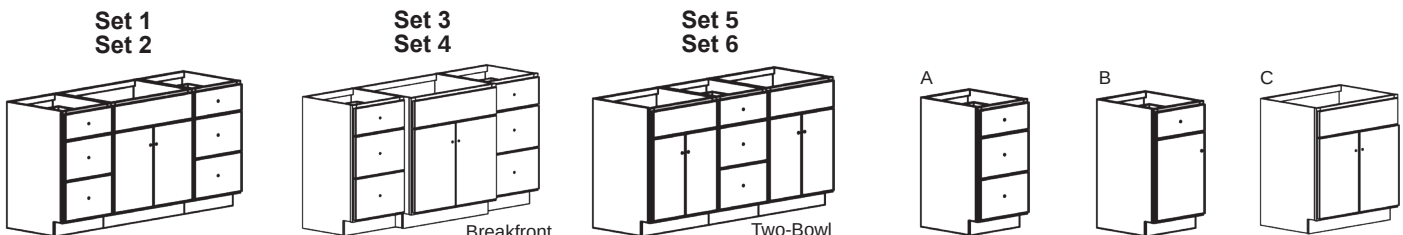

Vanity Sets 66" and 72" Wide and Set Component Models **3**

Example Item Number	Depth	1	Model Number	2	Collection Code (T,U)	3	Door Style Code (O, P, S, W)	4	Wood and Color Code	List
1A66211 T S C M-	21 3/4"		1A66211		T		S		C M-	\$3,292
1A66181 T S C M-	18 3/4"		1A66181		T		S		C M-	\$3,292

2 Collectaion Code:		Tuscany (T)			Ulverston (U)			
3 Door Style Code: See page 3.2 for Best Seller and Recommended Door Style Choices.		O Old Town	P Prestige	S Shaker	W Wilton	P Prestige	S Shaker	W Wilton
4 Wood & Color: See Wood-Color Brochure pages 7.1-7.2		STAIN Oak			STAIN Cherry Maple		STAIN —	
Ref	Notes	1 Model Number		GLAZE or PAINT Oak	GLAZE or PAINT Cherry Maple	GLAZE or PAINT Oak	GLAZE or PAINT Cherry Maple	GLAZE or PAINT Cherry Maple

66" Vanity Sets 66"W x 21 3/4" (or 18 3/4")D x 33 1/2"H

1		1A66211	3135	3292	3636	3135	3292	3636
3	4	1B66211	3219	3380	3734	3219	3380	3734
5	3	2A66211	2542	2669	2950	2542	2669	2950

72" Vanity Sets 72"W x 21 3/4" (or 18 3/4")D x 33 1/2"H

2		1A72211	3282	3446	3807	3282	3446	3807
4	4	1B72211	3219	3380	3734	3219	3380	3734
6	3	2A72211	2688	2823	3118	2688	2823	3118

Vanity Base Models for Left/Right End 18"W x 21 3/4" (or 18 3/4")D x 33 1/2"H

A	1	AD1821L	1157	1215	1342	1157	1215	1342
B	1	AV1821L	847	889	983	847	889	983

Vanity Base Models for Center 18"W x 21 3/4" (or 18 3/4")D x 33 1/2"H

C	2	AD1821N	1060	1113	1230	1060	1113	1230
---	---	---------	------	------	------	------	------	------

Vanity Base Models for Left/Right End 24", 27" or 30"W x 21 3/4" (or 18 3/4")D x 33 1/2"H

D	1,6	BV2421L	741	778	860	741	778	860
D	1,6	BV2721L	814	855	944	814	855	944
D	1,6	BV3021L	886	930	1028	886	930	1028

Vanity Base Models for Breakfront Left/Right End 12", 15", or 18"W x 18 3/4"D x 33 1/2"H

E	5	BD12BL-	1009	1059	1170	1009	1059	1170
E	5	BD15BL-	1136	1193	1318	1136	1193	1318
E	5	BD18BL-	1263	1326	1465	1263	1326	1465

Vanity Sink Models for Center 30" or 36"W x 21 3/4" (or 18 3/4")D x 33 1/2"H

F	2	BV3021N	821	862	952	821	862	952
F	2	BV3621N	968	1016	1123	968	1016	1123

- Notes & Exceptions
- 21 3/4" deep models are listed. For 18 3/4" deep models at the same price, place the "18" in position 5-6 of the Model No.
 - 1 The "L" in position 7 of the model number denotes Left End Finished, where the Right end will have a clear-coat finish but will not be stained, painted or glazed. To denote Right End Finished, place an "R" in position 7 of the model number, and the left end will have a clear-coat finish but will not be stained, painted or glazed.
 - 2 The "N" in position 7 of the model number denotes Neither End Finished, where both ends will have a clear-coat finish, but will not be stained, painted or glazed.
 - 3 Two bowl 66" vanity bowl centers are 12" from each end. Two bowl 72" vanity bowl centers are 13 1/2" from each end.
 - 4 For this Breakfront Vanity Set, the Center bowl area is 21 3/4" deep and the sides are 18 3/4" deep.
 - 5 The "L" in position 6 of the model number denotes Left End Finished, where the Right end will have a clear-coat finish but will not be stained, painted or glazed. To denote Right End Finished, place an "R" in position 7 of the model number, and the left end will have a clear-coat finish but will not be stained, painted or glazed.
 - 6 For this model with both ends finished, replace the "L" in position 7 with a "-" dash.

Cabinet graphics are shown below with nonspecific hardware, and Zenith (Z) door style. See pages 3.4-3.9 for specific Collection and Door Style information.

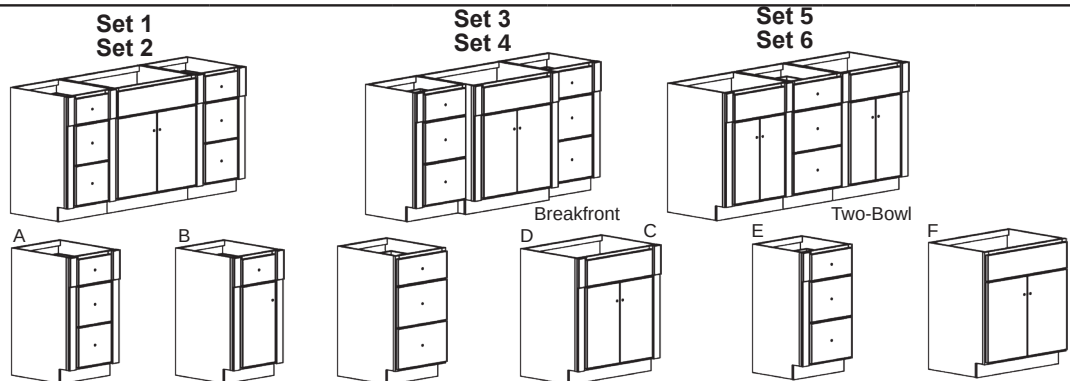

3 Toilet Toppers and Linen Cabinets

Example Item Number	Depth	1 Model Number	2 Collection Code (B,Q,R,S)	3 Door Style Code (O,P,S,W)	4 Wood and Color Code	List
LC1821L B P C M-	21 3/4"	LC1821L	B	P	C M-	\$1,867
LC1818L B P C M-	18 3/4"	LC1818L	B	P	C M-	\$1,867

2 Collection Code:	Bedford (B) or Revere (R)	Quentin (Q)	Springhill (S)
3 Door Style Code:	P Prestige S Shaker W Wilton	N Newport	O Old Town P Prestige S Shaker W Wilton
See page 3.2 for Best Seller and Recommended Door Style Choices.			
4 Wood & Color:	STAIN Oak	STAIN Cherry C Rustic Maple	STAIN Oak
See Wood-Color Brochure pages 7.1-7.2	GLAZE or PAINT Oak	GLAZE or PAINT Cherry C Rustic Maple	STAIN —
Ref	Notes	1 Model Number	RTF Maple-White

Toilet Toppers 21 3/8"W x 8 1/4"D x 30 5/8"H (WT2108-) or 24"W x 11 1/8"D x 33 7/8"H (WT2410-)

A	1,2	WT2108-	525	551	609	NA	525	551	609
B	1,2	WT2410-	649	681	753	627	649	681	753

Linen Cabinets 18" and 24" Widths 18" (or 24")W x 21 3/4" (or 18 3/4")D x 85 3/4"H

C	1,2,5,7	LC1821L	1778	1867	2062	1706	1778	1867	2062
C	1,2,5,7	LC2421L	2081	2185	2414	NA	2081	2185	2414
D	1,2,5	LJ2421-	2317	2433	2688	NA	2317	2433	2688
E	1,2,7	LD1821L	1966	2064	2281	NA	2047	2149	2375
F	1,2	LF2421-	2426	2547	2814	NA	2507	2632	2908
G	1,2,5,7	LB1821L	1788	1877	2074	NA	1788	1877	2074
H	1,2,5	LB2421-	2325	2441	2697	NA	2325	2441	2697
I	1,2,6,7	LH1821L	1988	2087	2306	NA	1988	2087	2306

Linen Cabinet Fillers 3" and 6" Widths 21" (or 18")D x 84"H

J	1,3,4	BSFBC3-	119	119	119	119	119	119	119
J	1,3,4	BSFBC6-	172	172	172	172	172	172	172

Notes & Exceptions

- The crown molding sub-assembly is shipped unattached to wall storage cabinets with instructions for easy attachment.
- Toilet Topper, Model WT2108-, has one adjustable shelf. Toilet Topper, Model WT2410-, has two adjustable shelves.

1 Cherry Rustic wood is not available in Revere Collection. Wilton door style is not available in Cherry Rustic
 2 For crown molding add 1/2" to depth and 2 1/2" to width. For models with crown molding placed next to wall, specify which one(s) are next to wall(s) and add \$55 to list price for each end.
 3 Filler Board is not counted as a piece for quantity discounts.
 4 For this model, place a dash "-" for the Door Style Code.
 5 Available also in 12 3/4" or 15 3/4" depth for the price listed. To order place "12" or "15" in positions 5-6 of model number.
 6 This model is only available in 21 3/4" depth.
 7 For door hinged right, place an "R" in position 7 of the model number.

Cabinet graphics are shown below with nonspecific hardware, and Zenith (Z) door style. See pages 3.4-3.9 for specific Collection and Door Style information.

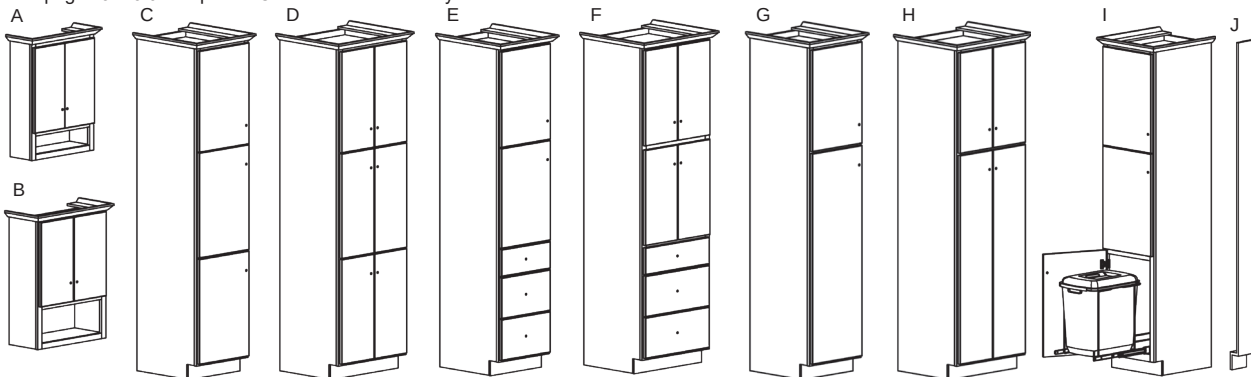

Toilet Toppers and Linen Cabinets

3

Example Item Number	Depth	1	Model Number	2	Collection Code (T,U)	3	Door Style Code (O,P,S,W)	4	Wood and Color Code	List
LC1821L T S C M-	21 3/4"		LC1821L		T		S		C M	\$2,046
LC1818L T S C M-	18 3/4"		LC1818L		T		S		C M-	\$2,046

2		Tuscany (T)				Ulverston (U)			
3		O	P	S	W	P	S	W	
Door Style Code:		Old Town	Prestige	Shaker	Wilton	Prestige	Shaker	Wilton	
See page 3.2 for Best Seller and Recommended Door Style Choices.									
4		1		STAIN		STAIN		STAIN	
Wood & Color:		See Wood-Color Brochure pages 7.1-7.2		Oak	Cherry Maple	—	Oak	Cherry Maple	—
Ref	Notes	Model Number		Oak	Cherry Maple	—	Oak	Cherry Maple	—
				GLAZE or PAINT	GLAZE or PAINT	—	GLAZE or PAINT	GLAZE or PAINT	GLAZE or PAINT

Toilet Toppers		24"W x 8 3/4"D x 30 3/8"H (WT2408-) or 24"W x 11 1/8"D x 33 1/2"H (WT2410-)						
A	1	WT2408-	828	869	960	828	869	960
B	1	WT2410-	881	925	1022	881	925	1022

Linen Cabinets 18" and 24" Widths		18" (or 24")W x 21 3/4" (or 18 3/4")D x 85 3/4"H						
C	1,4,5	LC1821L	1949	2046	2261	1949	2046	2261
C	1,4,5	LC2421L	2251	2364	2611	2251	2364	2611
D	1,4	LJ2421-	2488	2612	2886	2488	2612	2886
E	1,5	LD1821L	2218	2329	2573	2218	2329	2573
E	1,5	LD2421L	2369	2487	2748	2369	2487	2748
F	1	LF2421-	2677	2811	3105	2677	2811	3105
G	1,4,5	LB1821L	1957	2055	2270	1957	2055	2270
G	1,4,5	LB2421L	2259	2372	2620	2259	2372	2620
H	1,7,5,6	LH2421L	2763	2901	3205	2763	2901	3205

Linen Cabinet Fillers 3" and 6" Widths		21" (or 18")D x 84"H						
I	2,3	BSFBC3-	119	119	119	119	119	119
I	2,3	BSFBC6-	172	172	172	172	172	172

Notes & Exceptions

- The crown molding sub-assembly is shipped unattached to wall storage cabinets with instructions for easy attachment.
- Toilet Topper, Model WT2408- ,has one adjustable shelf. Toilet Topper, Model WT2410- , has two adjustable shelves.

1 For crown molding add 1 1/4" to depth and 2 1/2" to width. For models with crown molding placed next to wall, specify which one(s) are next to wall(s) and add \$55 to list price for each end.

2 Filler Board is not counted as a piece for quantity discounts.

3 For this model, place a dash "-" for the Door Style Code.

4 Available also in 12 3/4" or 15 3/4" depth for the price listed. To order place "12" or "15" in positions 5-6 of model number.

5 For door hinged right, place an "R" in position 7 of the model number.

6 This model only available in 21 3/4" depth.

ROYALE STORAGE

Cabinet graphics are shown below with nonspecific hardware, and Zenith (Z) door style. See pages 3.4-3.9 for specific Collection and Door Style information.

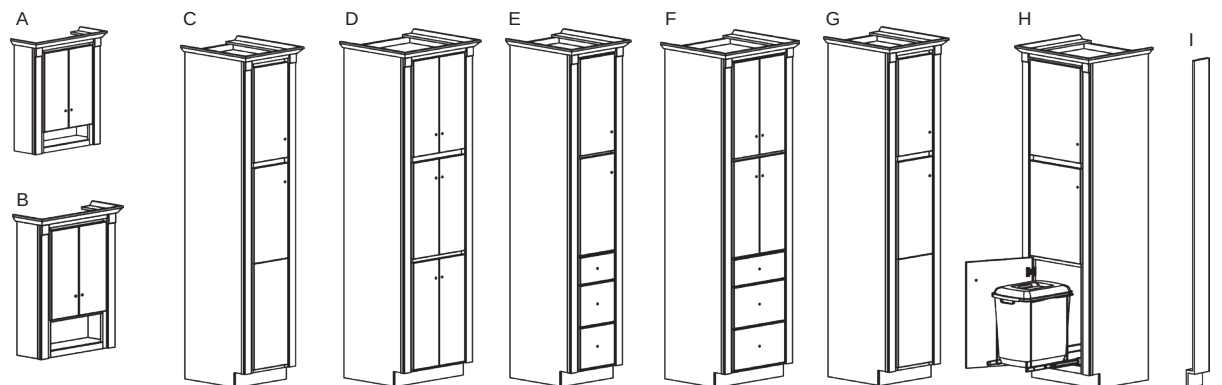

Natural Granite Tops

to Complement Royale Vanities

5

Available March 27, 2017

These value priced tops are 3/4" thick and have a white oval bowl.



Wheat (22)



Meteorite (33)



Wheat Top

For 4" x 4" color samples of the above 2 colors order Item Number QMGSMPL-SET for a list price of \$20.

Example Item Number	Bowl Shape	Depth	1	Model Number	2	Bowl Color Code (W)	3	Top Color Code (22 or 33)	4	Faucet Hole Drilling Code (8)	List
MG2522- W 22 8	Std. Oval	22"		MG2522-		W		22		8	\$525

1		Model Number Position 1-2	
Code	Bowl Shape		
MG	Standard Oval for 22" depth		
1		Model Number Positions 5-7	
Code	Depth		
22-	22" depth		
2		Undermount Bowl Color Code Position 8	
Code	Color		
W	White		
3		Top Color Codes Position 9-10	
22	Wheat		
33	Meteorite		
4		Faucet Hole Drilling Position 11	
Code	Color		
8	8" drilling		

1	Fits Cabinet Width	Model Number	Notes	Width	Bowls	Bowl Center	List Price with Backsplash
One-Bowl Granite Tops (Depth: 22")							
24"		MG2522-		25	1	Centered	525
30"		MG3122-		31	1	Centered	595
36"		MG3722-		37	1	Centered	640
42"		MG4322-		43	1	Centered	716
48"		MG4922-		49	1	Centered	760

Notes & Exceptions:

- Tops have finished ends and front edges.
- Bowls have built-in (integrated) overflow.
- Backsplashes are 3/4" thick, 4" high and have finished ends and finished top edge. They are separated from the top but included in same carton.
- One year limited warranty.

VANITY TOPS



Meteorite Top

Available in sizes to fit vanity widths of 24", 30", 36", 42" and 48"

Over 40 Years
Personalized Cabinetry for Your Bath

